

# CAB 3® marking system

for cables and Viking 3 terminal blocks

## ■ Dimensions

### Markers

Polyamide 6/6

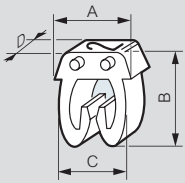

Dimensions	Cable cross section (mm²)			
	0-15 to 0-5	0-5 to 1-5	1-5 to 2-5	4 to 6
A (mm)	5	5	5-6	8
B (mm)	5-05	6-4	7-6	9-6
C (mm)	3-7	4-3	4-9	7-1
D (mm)	2-3	3	3	3
Ø min./max. (mm)	0-8/2-2	2-2/3	2-8/3-8	4-3/5-3

### Marker holders – for cable

Cat. No. 0384 90

Cat. No. 0384 91

Cat. No. 0384 92

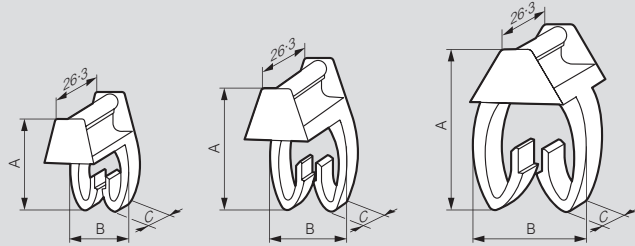

Dim.	Section of cable for marking (mm²)		
	10 to 16	25 to 35	50 to 70
A (mm)	18	24-3	27-2
B (mm)	8-9	12-2	17-2
C (mm)	7	7	10

### Marker holders – for Viking 3 terminal blocks

Cat. No. 0383 92

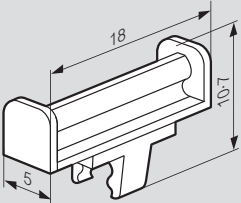

## On-site toolbox

Cat. No. 0382 00

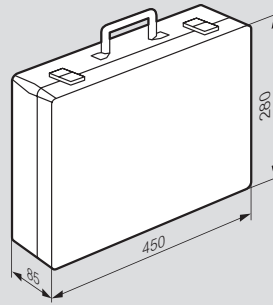

Bottom tray consists of :

- 8 medium slots (each slot takes 1 box of CAB 3)
- 1 large slot

Top tray consists of :

- 12 small slots (<=> approx. 6 boxes of CAB 3)
  - 1 medium slot for applicators
- Capacity : approx. 15000 CAB 3 markers

## ■ Examples

CAB 3 fitted on to Viking 3 terminal blocks using marker holder (Cat. No. 0383 92)



Fitted directly on to heavy duty terminal blocks

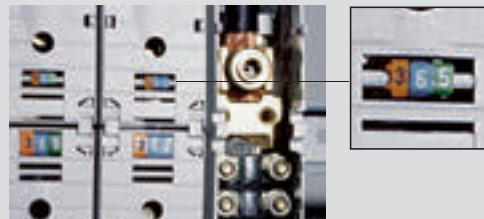

Fitted on to cable with marker holder (Cat. No. 0384 92)

